

CAPICORDA DA TUBO IN RAME NON ISOLATI

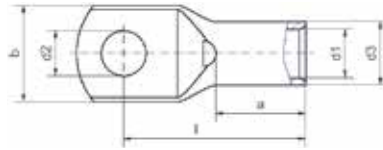

Capicorda da tubo: 1,5 - 630 mm<sup>2</sup>  
 Materiale: Rame CU-HCP 99,9% stagnato  
 Con foro d'ispezione



Sezione mm <sup>2</sup>	Foro	Tipo	Dimensioni mm						Ref. matrice	Confezione	Utensili							
			d1	d3	d2	b	l	a			MPR-1	MPR-2	MPR-3					
50	6	CI50-M6	9,6	13,1	6,4	19,0	36,0	18,0	*K13M	25			MPR-1	MPR-2	MPR-3	STILO50, HP50, PP60-1, AP60-1	PP230	PP130-C, HP1130-C, AP130-C, PP130-H, HP1130-H, AP130-H
	8	CI50-M8			8,4	19,0	37,0			25								
	10	CI50-M10			10,5	20,0	39,0			25								
	12	CI50-M12			13,0	23,0	40,5			25								
	14	CI50-M14			15,0	25,0	42,5			25								
	16	CI50-M16			17,0	27,0	45,5			25								
	20	CI50-M20			21,0	28,0	50,0			25								
70	6	CI70-M6	11,3	14,7	6,4	22,5	41,0	21,0	*K14	25								
	8	CI70-M8			8,4	22,5	41,0			25								
	10	CI70-M10			10,5	22,5	42,5			25								
	12	CI70-M12			13,0	23,0	43,5			25								
	14	CI70-M14			15,0	26,0	46,0			25								
	16	CI70-M16			17,0	28,0	48,5			25								
95	6	CI95-M6	13,5	17,5	6,4	25,0	46,0	23,0	*K17M	25								
	8	CI95-M8			8,4	25,0	45,5			25								
	10	CI95-M10			10,5	25,0	47,0			25								
	12	CI95-M12			13,0	26,0	47,0			25								
	14	CI95-M14			15,0	26,0	49,0			25								
	16	CI95-M16			17,0	28,0	50,0			25								
	20	CI95-M20			21,0	31,0	54,5			25								
120	8	CI120-M8	15,5	20,0	8,4	29,0	50,5	26,0	*K18	25								
	10	CI120-M10			10,5	29,0	53,0			25								
	12	CI120-M12			13,0	29,0	52,5			25								
	14	CI120-M14			15,0	29,0	53,5			25								
	16	CI120-M16			17,0	29,0	55,0			25								
	20	CI120-M20			21,0	35,0	60,0			25								
150	8	CI150-M8	16,8	21,3	8,4	31,0	55,5	29,0	*K20D	10								
	10	CI150-M10			10,5	31,0	56,5			10								
	12	CI150-M12			13,0	31,0	56,0			10								
	14	CI150-M14			15,0	31,0	57,0			10								
	16	CI150-M16			17,0	31,0	58,0			10								
	20	CI150-M20			21,0	35,0	63,0			10								
185	8	CI185-M8	19,0	24,0	8,4	35,0	58,0	30,0	*K22D	10								
	10	CI185-M10			10,5	35,0	59,0			10								
	12	CI185-M12			13,0	35,0	58,5			10								
	14	CI185-M14			15,0	35,0	61,0			10								
	16	CI185-M16			17,0	35,0	63,0			10								
	20	CI185-M20			21,0	35,0	66,0			10								

\* Per la selezione dell'utensile da pag. 121