

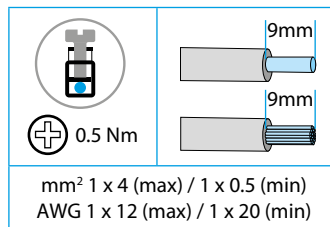

78.1B

IN	78.1B.1.230.2403 U_N (120...240)V AC (50/60 Hz) U_N 220 V DC $U_{min} - U_{max}$ 100 - 265 V AC (50/60 Hz) $U_{min} - U_{max}$ 140 - 275 V DC $P_{(stand-by)} < 1$ W
OUT	- [IN 230 V AC, (-20...+40)°C] 5 A (max 10 A - 5 ms) 24 V DC, 120 W - [IN (100...275)V, 40°C] 4.5 A (max 10 A - 5 ms), 24 V DC, 110 W
	(-20...+70)°C
IP20	



78	U_N	LED
OK	✓	
Sh	✓	15s. OFF
ThL	✓	OFF

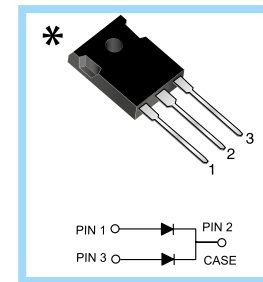
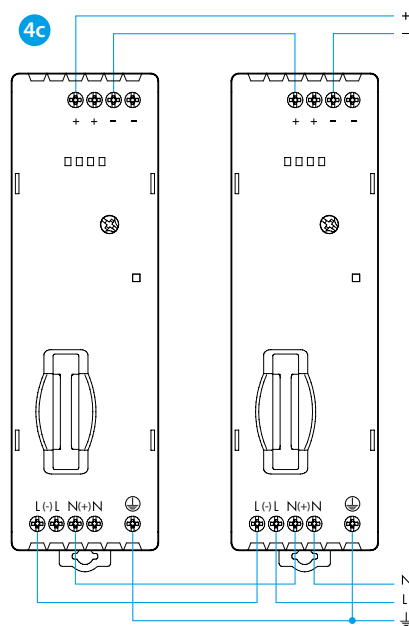
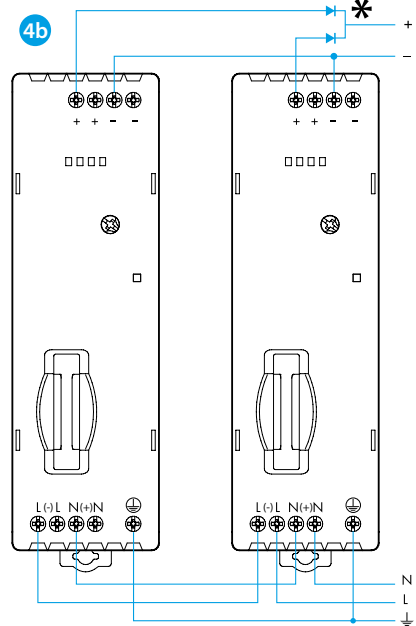
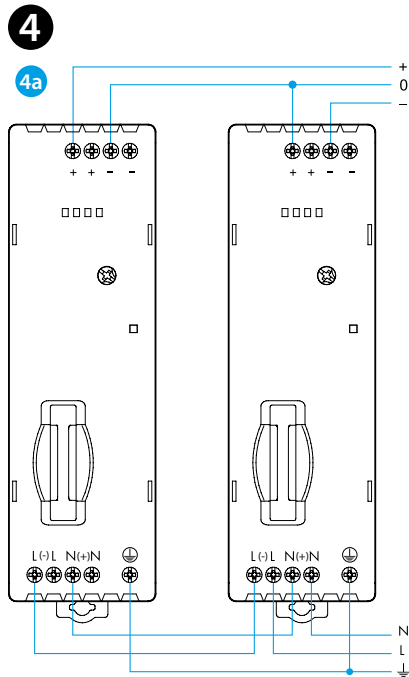
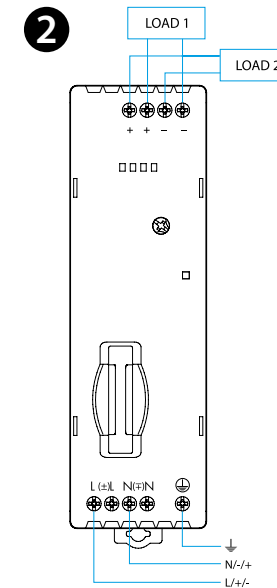
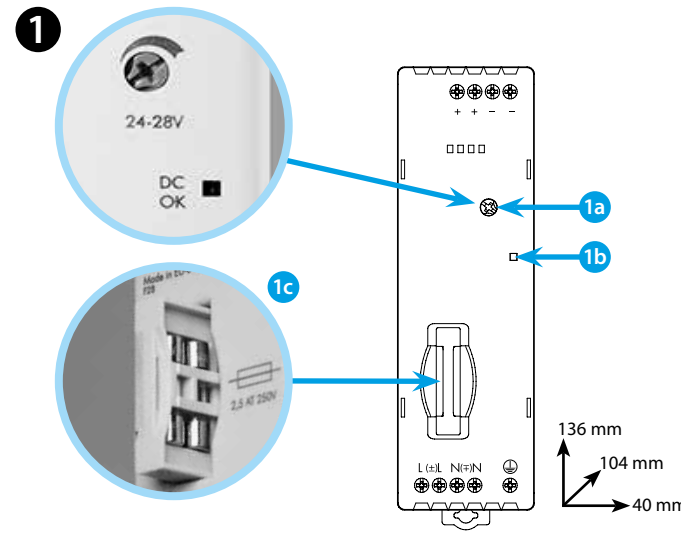

UL LISTED
IND. CONT. EQ.
E361251

Input 115 V AC 50/60 Hz / 1.65 A
Output 24 V DC, 4 A / 96 W
Input 230 V AC 50/60 Hz / 1.1 A
Output 24 V DC, 4.5 A / 108 W

- Open Type Equipment - Pollution Degree-2 Installation Environment
- Maximum Surrounding Air Temperature 40°C
- Use 60°C / 75°C copper (CU) conductor and wire ranges No. 14-18 AWG, stranded or solid
- The terminal tightening torque of 0.5 Nm

A readily accessible disconnect device shall be incorporated in the building installation wiring:

- Circuit breaker 6 A Z-curve
- Input fuse 3.15 A - T - F1
- Equipment intended for installation in restricted access location

ITALIANO

78.1B ALIMENTATORE SWITCHING

- 1** DIMENSIONI / QUADRO FRONTALE
1a Regolatore tensione nominale di uscita da 24 a 28 V DC
1b LED verde: segnalazione stato dell'uscita
1c Fusibile di protezione della tensione di ingresso
 (Fusibile: 3.15 A-T - piu fusibile di ricambio)

2 SCHEMA DI COLLEGAMENTO

3 TABELLA LED E FUNZIONI

- U_N Alimentazione AC/DC
- Sh Corto circuito
- ThL Limite termico
- Led (**1b**) LED Verde

4 ESEMPI DI COLLEGAMENTO

- 4a** Collegamento Duale
- 4b** Collegamento in parallelo ($I \leq 2 \times I_N$)
* **MBR 4060PT**
(**TO247**)
- 4c** Collegamento in serie

NOTE

- Rendimento: 93% @ 230 V AC
- Protezione automatica al corto circuito